

① Board dimensions (top view)
Scale 5:1

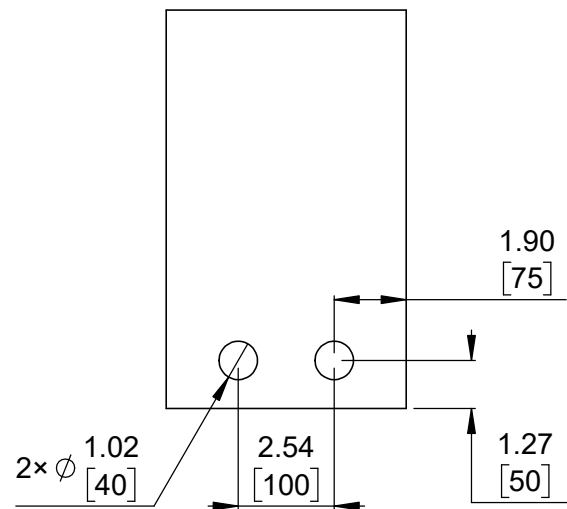

② Connector callouts (bottom view)
Scale 5:1

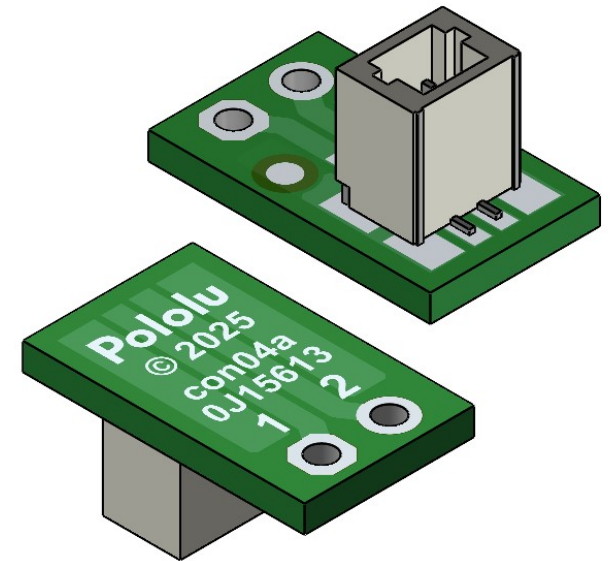

③ Isometric view
Scale 5:1

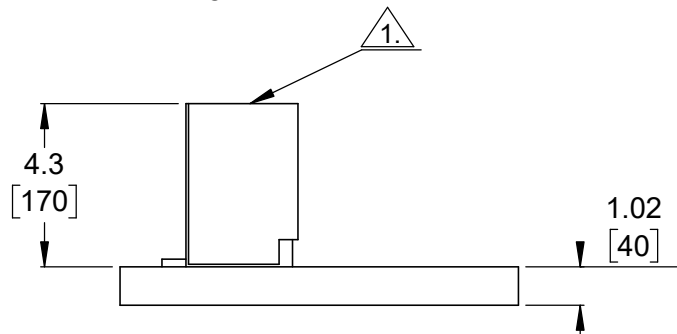

④ Profile
Scale 5:1



⑤ Actual size
Scale 1:1

- 1.
- 2.
- 3.
- 4.

Top-entry, 2-pin male JST SH-style connector.
To get the specified scale, select 100% in print settings.
Drill location tolerance: ± 0.1 [± 5].
Board edge tolerance: ± 0.3 [± 10].

<https://www.pololu.com/product/4810>

Name: Breakout for JST SH-Style Connector, 2-Pin Male Top-Entry		Item number: 4810
Drawing date: 13 June 2025	Dev code: con04a	 © 2025 Pololu Corporation
Units: mm [mil]	Material: mixed	

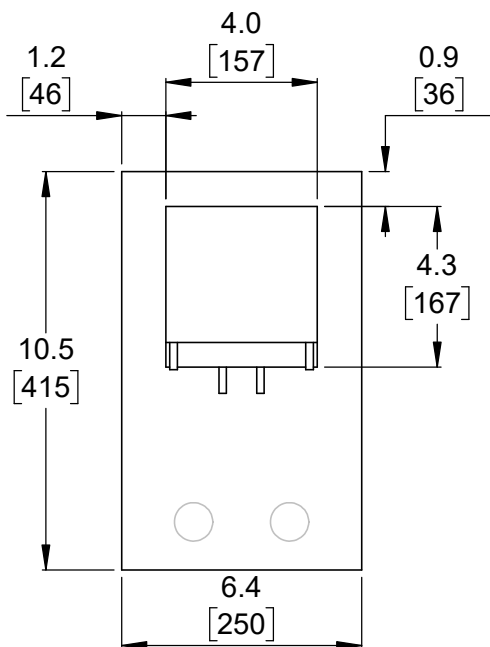

① Board dimensions (top view)
Scale 5:1

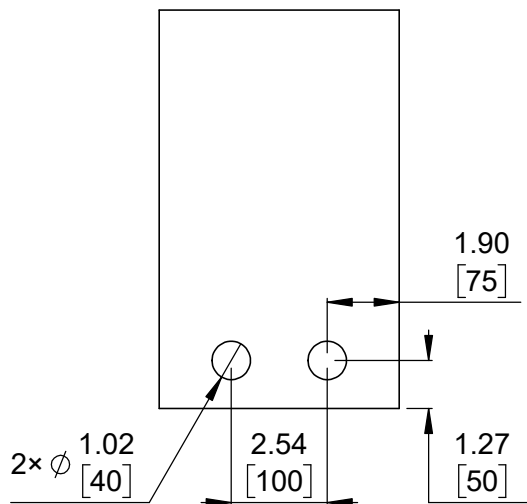

② Connector callouts (bottom view)
Scale 5:1

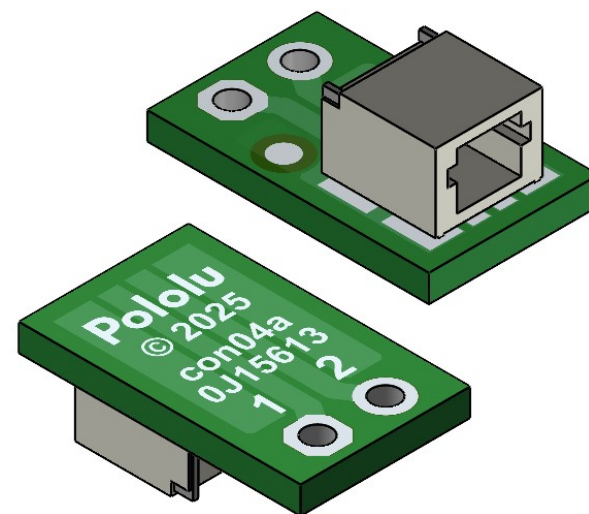

③ Isometric view
Scale 5:1

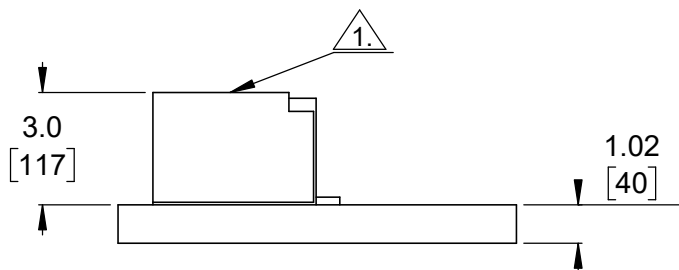

④ Profile
Scale 5:1



⑤ Actual size
Scale 1:1

- 1.
- 2.
- 3.
- 4.

Side-entry, 2-pin male JST SH-style connector.
To get the specified scale, select 100% in print settings.
Drill location tolerance: ± 0.1 [± 5].
Board edge tolerance: ± 0.3 [± 10].

<https://www.pololu.com/product/4811>

Name:
Breakout for JST SH-Style Connector,
2-Pin Male Side-Entry

Item number:
4811

Drawing date:
13 June 2025

Dev code:
con04a

Units: mm
[mil]

Material:
mixed

Pololu
Robotics & Electronics
© 2025 Pololu Corporation

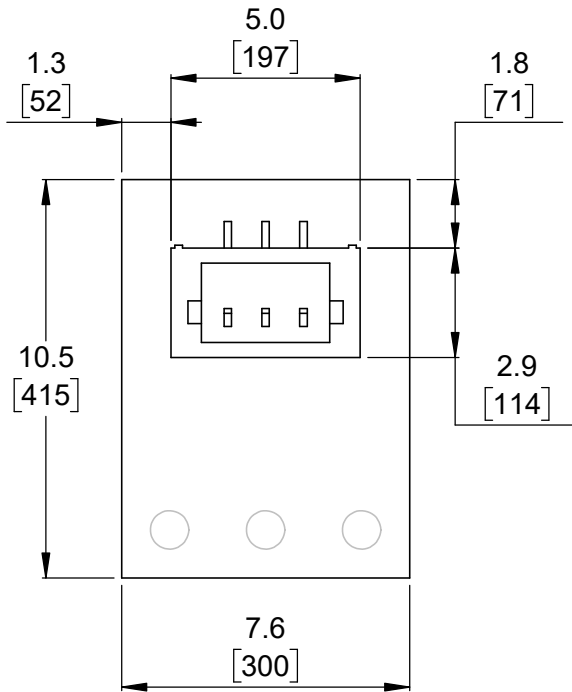

① Board dimensions (top view)
Scale 5:1

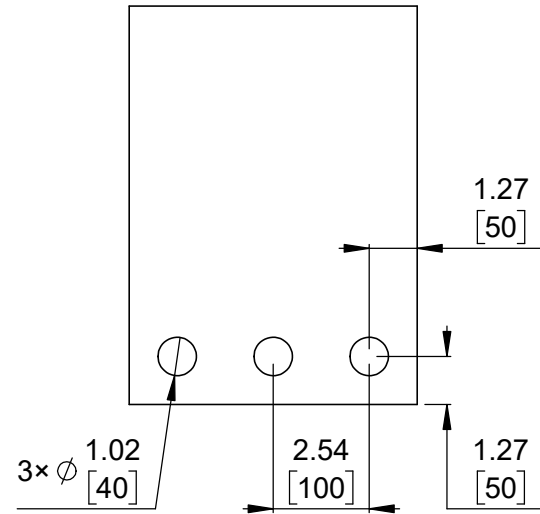

② Connector callouts (bottom view)
Scale 5:1

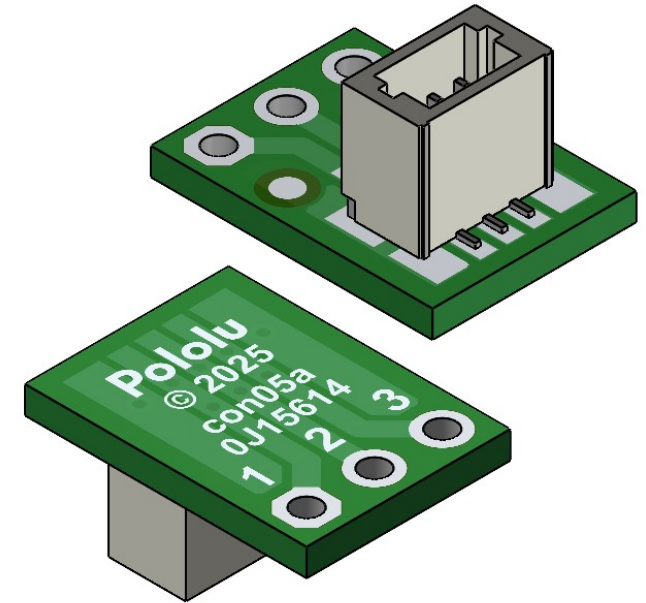

③ Isometric view
Scale 5:1

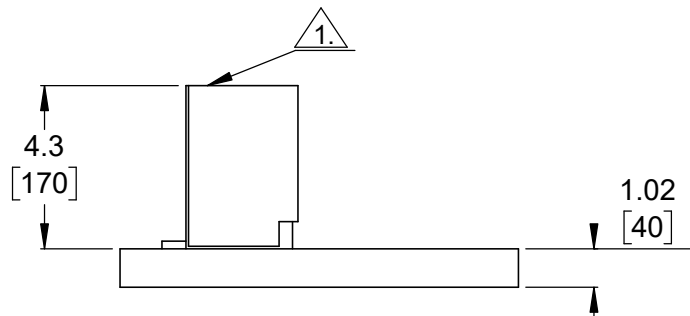

④ Profile
Scale 5:1



⑤ Actual size
Scale 1:1

1. Top-entry, 3-pin male JST SH-style connector.
2. To get the specified scale, select 100% in print settings.
3. Drill location tolerance: ± 0.1 [± 5].
4. Board edge tolerance: ± 0.3 [± 10].

<https://www.pololu.com/product/4812>

Name: Breakout for JST SH-Style Connector, 3-Pin Male Top-Entry		Item number: 4812
Drawing date: 13 June 2025	Dev code: con05a	 © 2025 Pololu Corporation
Units: mm [mil]	Material: mixed	

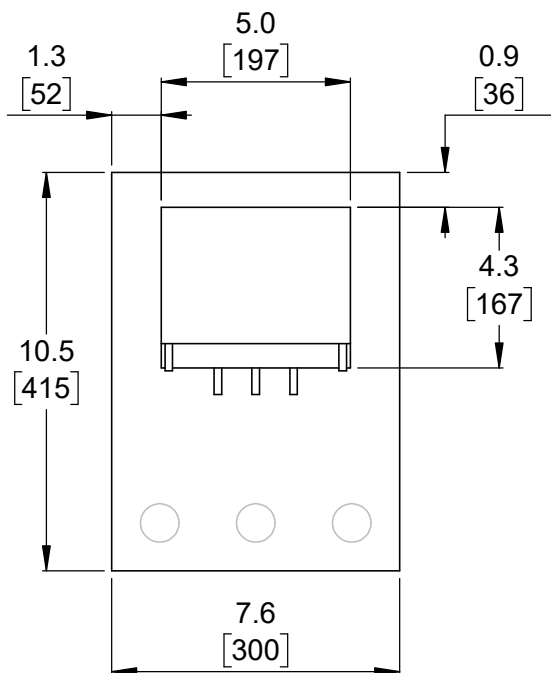

① Board dimensions (top view)
Scale 5:1

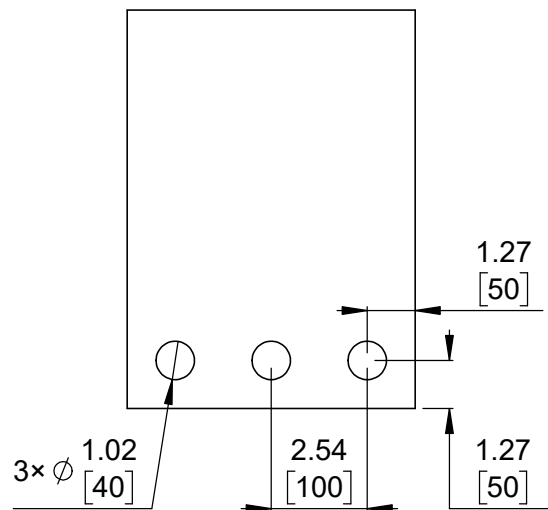

② Connector callouts (bottom view)
Scale 5:1

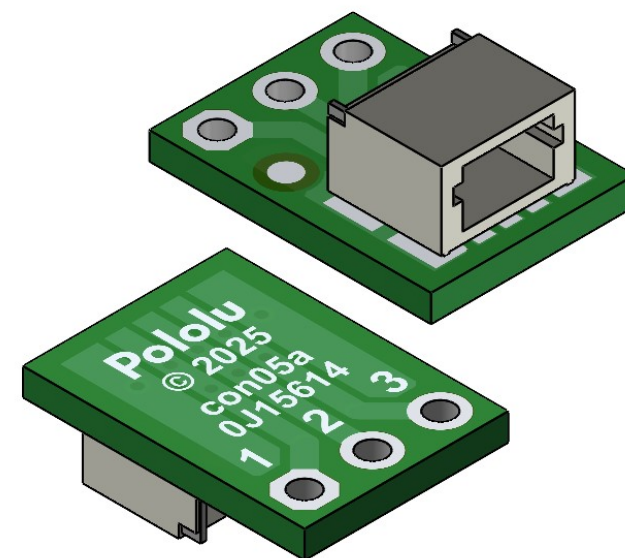

③ Isometric view
Scale 5:1

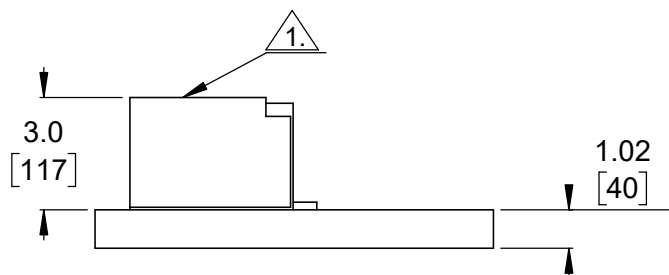

④ Profile
Scale 5:1



⑤ Actual size
Scale 1:1

- 1.
- 2.
- 3.
- 4.

Side-entry, 3-pin male JST SH-style connector.
To get the specified scale, select 100% in print settings.
Drill location tolerance: ± 0.1 [± 5].
Board edge tolerance: ± 0.3 [± 10].

<https://www.pololu.com/product/4813>

Name: Breakout for JST SH-Style Connector, 3-Pin Male Side-Entry		Item number: 4813
Drawing date: 13 June 2025	Dev code: con05a	
Units: mm [mil]	Material: mixed	

Pololu
Robotics & Electronics
© 2025 Pololu Corporation

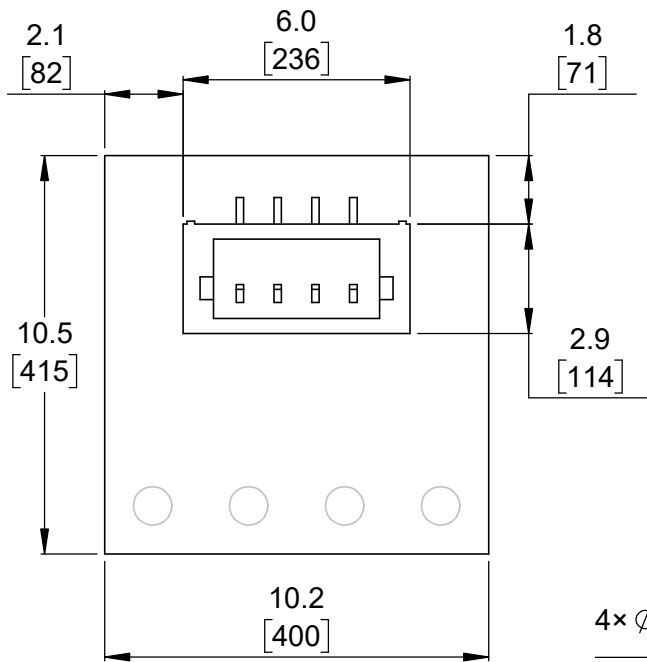

① Board dimensions (top view)
Scale 5:1

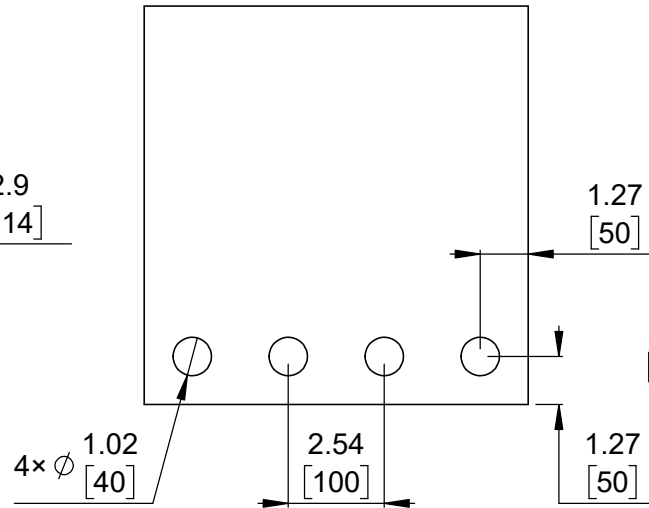

② Connector callouts (bottom view)
Scale 5:1

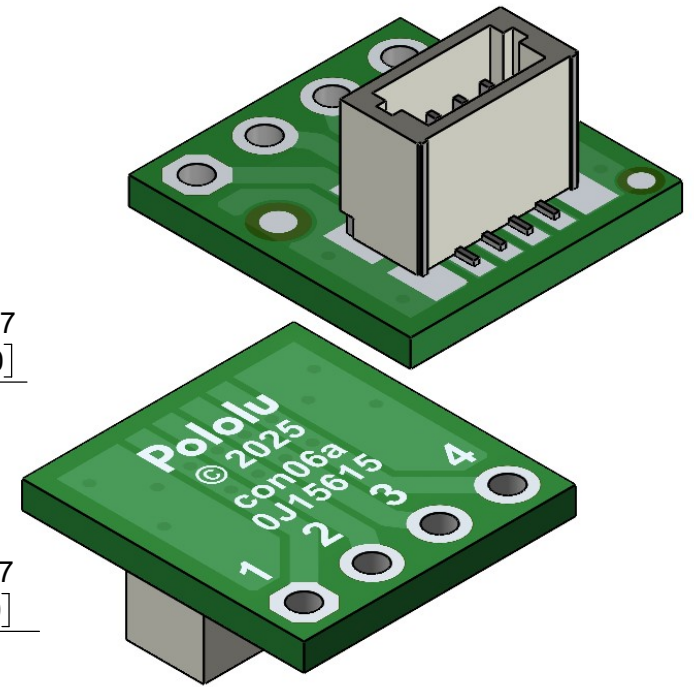

③ Isometric view
Scale 5:1

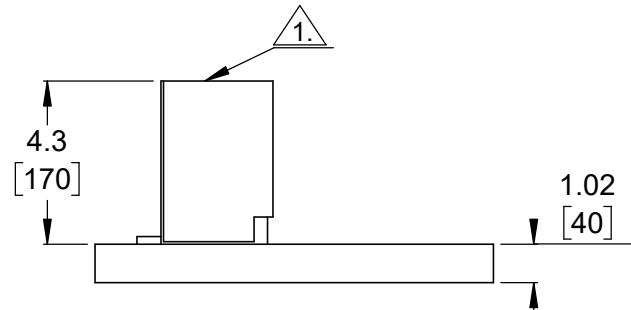

④ Profile
Scale 5:1



⑤ Actual size
Scale 1:1

1. Top-entry, 4-pin male JST SH-style connector.
2. To get the specified scale, select 100% in print settings.
3. Drill location tolerance: ± 0.1 [± 5].
4. Board edge tolerance: ± 0.3 [± 10].

<https://www.pololu.com/product/4814>

Name: Breakout for JST SH-Style Connector, 4-Pin Male Top-Entry		Item number: 4814
Drawing date: 13 June 2025	Dev code: con06a	 © 2025 Pololu Corporation
Units: mm [mil]	Material: mixed	

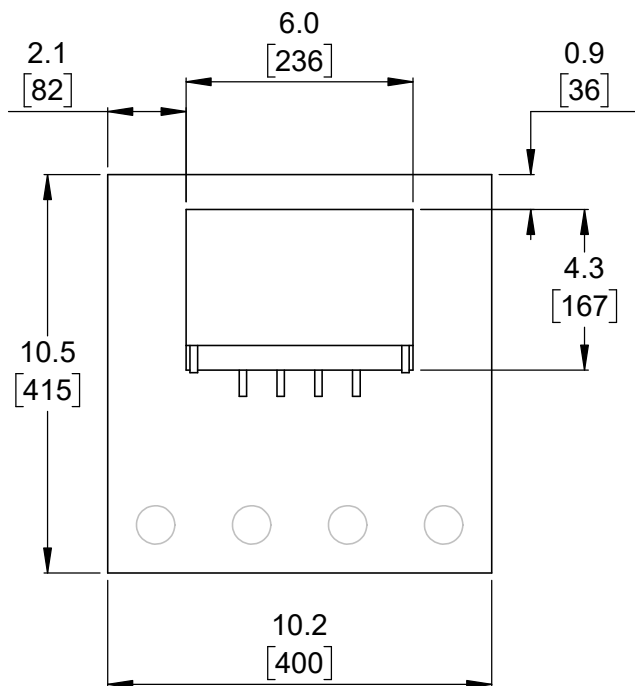

① Board dimensions (top view)
Scale 5:1

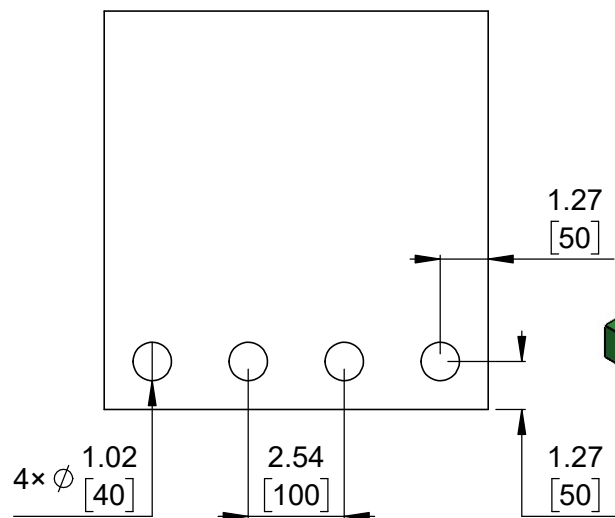

② Connector callouts (bottom view)
Scale 5:1

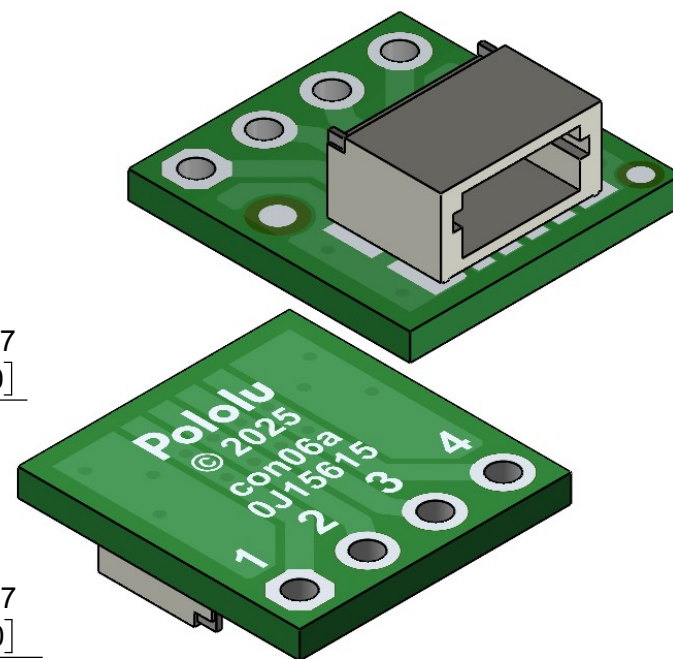

③ Isometric view
Scale 5:1

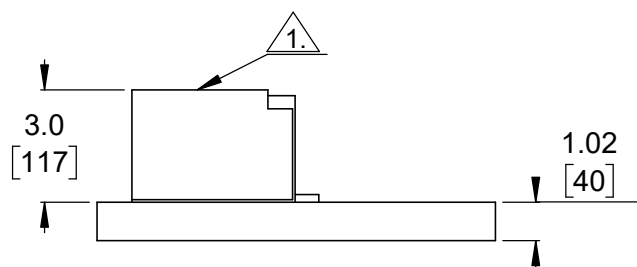

④ Profile
Scale 5:1



⑤ Actual size
Scale 1:1

- 1.
- 2.
- 3.
- 4.

Side-entry, 4-pin male JST SH-style connector.
To get the specified scale, select 100% in print settings.
Drill location tolerance: ± 0.1 [± 5].
Board edge tolerance: ± 0.3 [± 10].

<https://www.pololu.com/product/4815>

Name: Breakout for JST SH-Style Connector, 4-Pin Male Side-Entry		Item number: 4815
Drawing date: 13 June 2025	Dev code: con06a	
Units: mm [mil]	Material: mixed	

Pololu
Robotics & Electronics
© 2025 Pololu Corporation

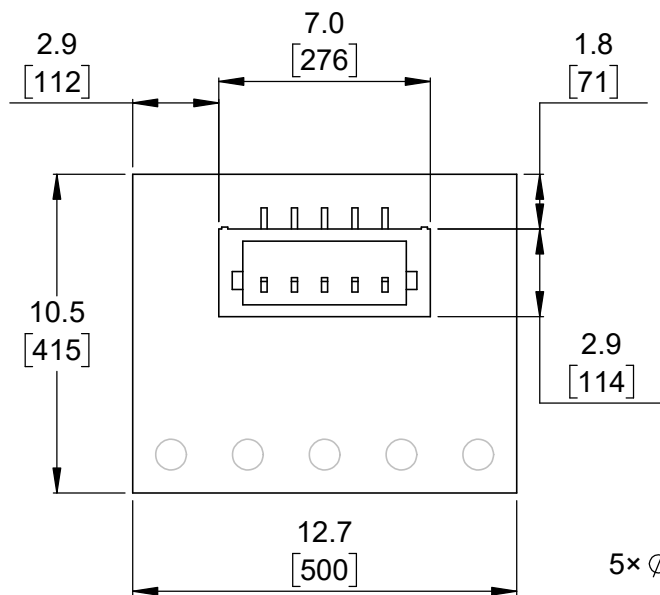

① Board dimensions (top view)
Scale 4:1

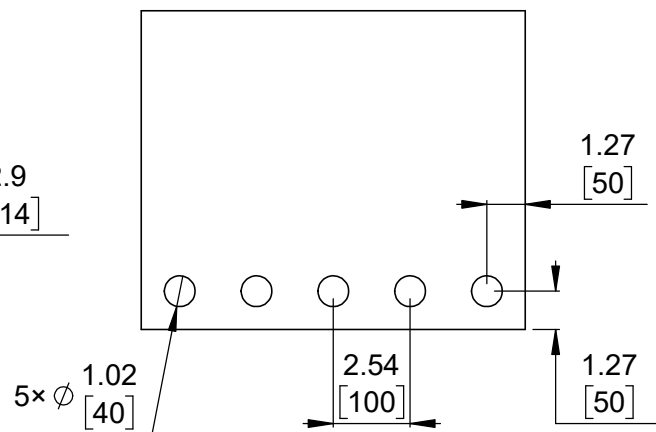

② Connector callouts (bottom view)
Scale 4:1

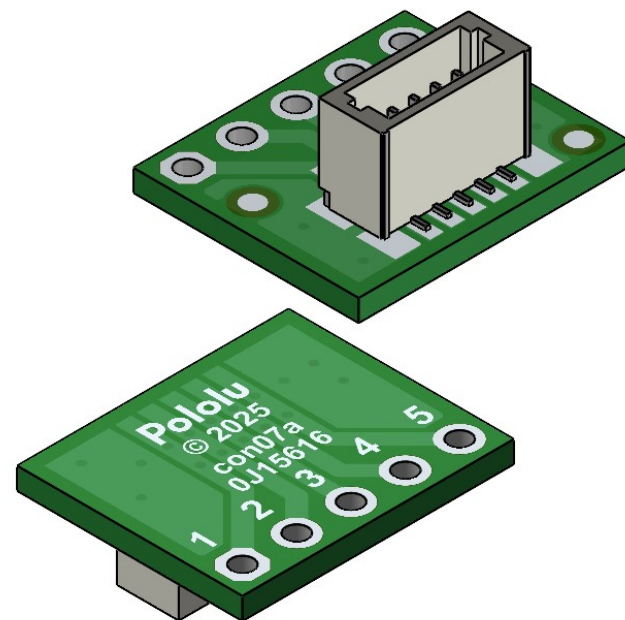

③ Isometric view
Scale 4:1

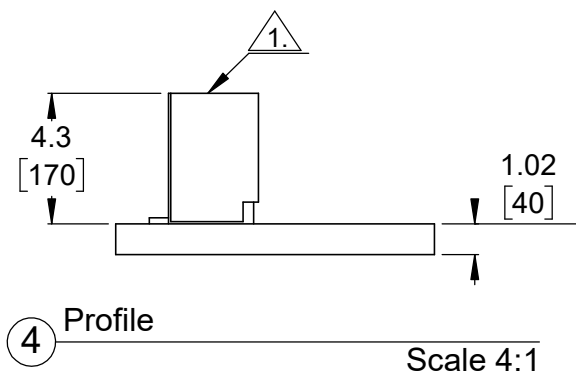

④ Profile
Scale 4:1

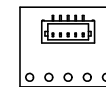

⑤ Actual size
Scale 1:1

1. Top-entry, 5-pin male JST SH-style connector.
 2. To get the specified scale, select 100% in print settings.
 3. Drill location tolerance: ± 0.1 [± 5].
 4. Board edge tolerance: ± 0.3 [± 10].

<https://www.pololu.com/product/4816>

Name: Breakout for JST SH-Style Connector, 5-Pin Male Top-Entry		Item number: 4816
Drawing date: 13 June 2025	Dev code: con07a	 © 2025 Pololu Corporation
Units: mm [mil]	Material: mixed	

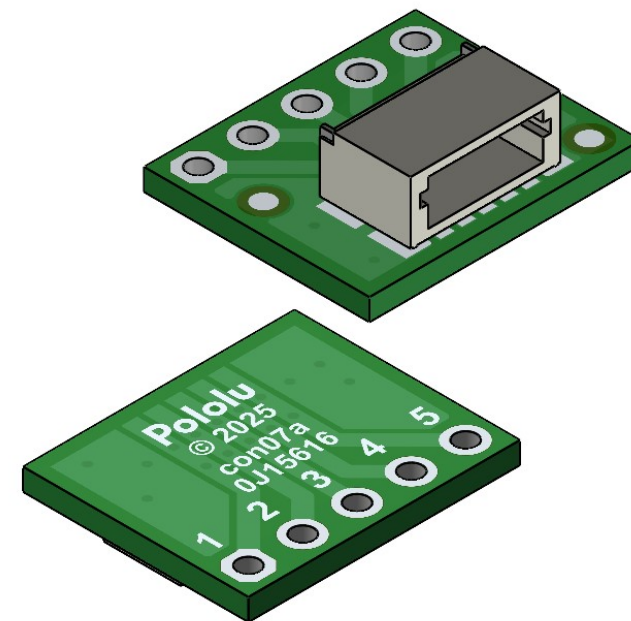
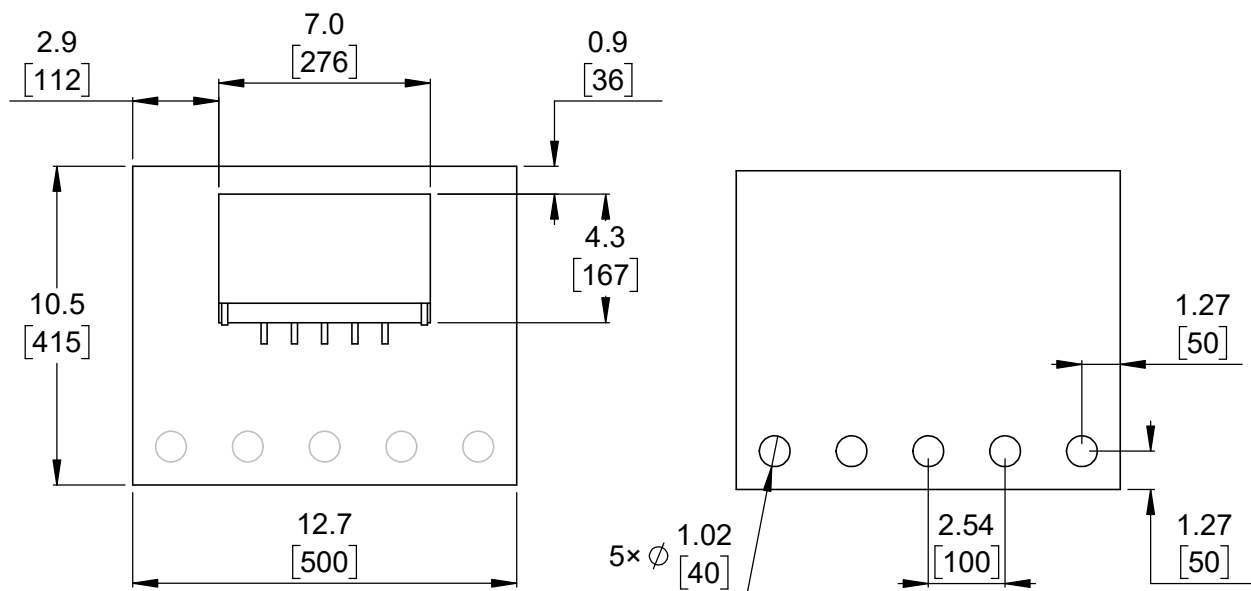

① Board dimensions (top view)
Scale 4:1

② Connector callouts (bottom view)
Scale 4:1

③ Isometric view
Scale 4:1

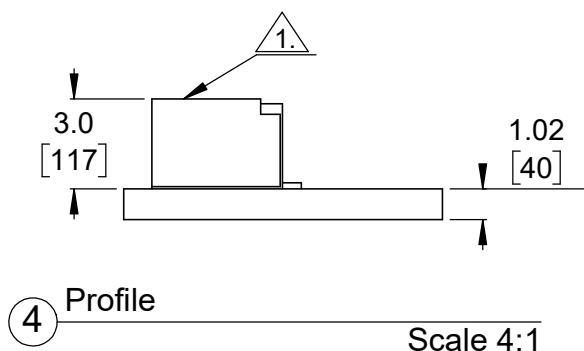

④ Profile
Scale 4:1

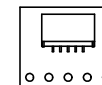

⑤ Actual size
Scale 1:1

1. Side-entry, 5-pin male JST SH-style connector.
 2. To get the specified scale, select 100% in print settings.
 3. Drill location tolerance: ± 0.1 [± 5].
 4. Board edge tolerance: ± 0.3 [± 10].

<https://www.pololu.com/product/4817>

Name: Breakout for JST SH-Style Connector, 5-Pin Male Side-Entry		Item number: 4817
Drawing date: 13 June 2025	Dev code: con07a	
Units: mm [mil]	Material: mixed	

Pololu
Robotics & Electronics
© 2025 Pololu Corporation

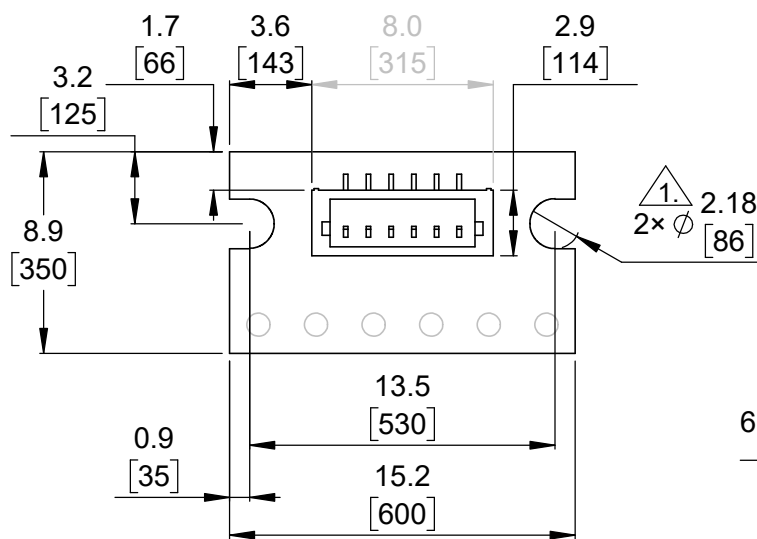

① Board dimensions (top view)
Scale 3:1

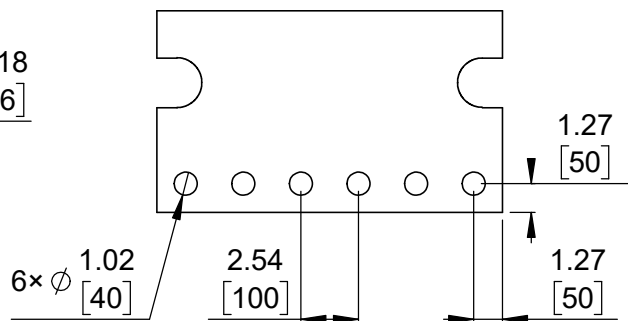

② Connector callouts (bottom view)
Scale 3:1

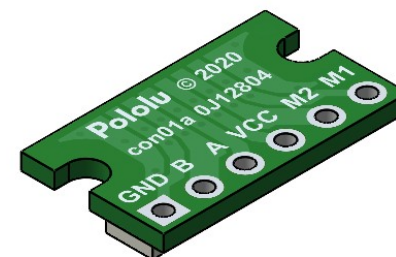
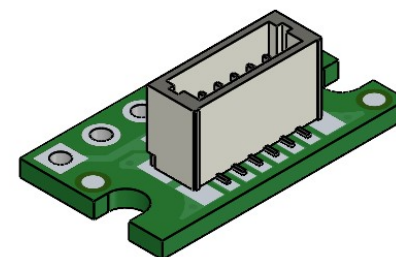

③ Isometric view
Scale 3:1

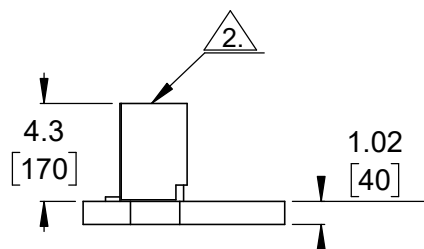

④ Profile
Scale 3:1

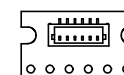

⑤ Actual size
Scale 1:1



Intended for #2 or M2 screws.



Top-entry, 6-pin male JST SH-style connector.

To get the specified scale, select 100% in print settings.

Drill location tolerance: ± 0.1 [± 5].

Board edge tolerance: ± 0.3 [± 10].

<https://www.pololu.com/product/4770>

Name:
Breakout for JST SH-Style Connector,
6-Pin Male Top-Entry

Item number:
4770, 4771

Drawing date:
13 June 2025

Dev code:
con01a

Units: mm
[mil]

Material:
mixed

Pololu
Robotics & Electronics
© 2025 Pololu Corporation

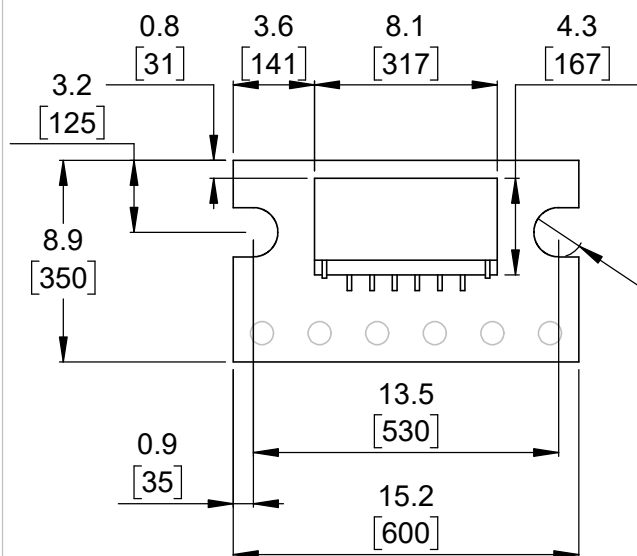

① Board dimensions (top view)
Scale 3:1

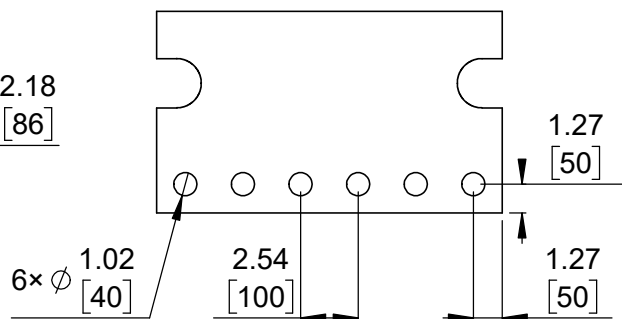

② Connector callouts (bottom view)
Scale 3:1

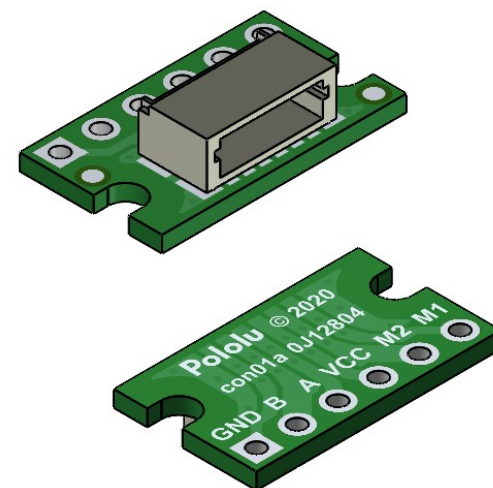

③ Isometric view
Scale 3:1

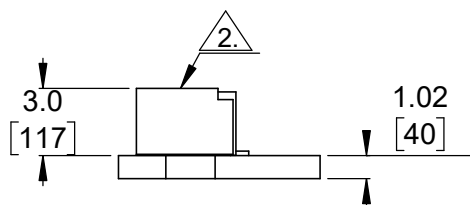

④ Profile
Scale 3:1

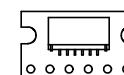

⑤ Actual size
Scale 1:1



Intended for #2 or M2 screws.



Side-entry, 6-pin male JST SH-style connector.

3. To get the specified scale, select 100% in print settings.

4. Drill location tolerance: ± 0.1 [± 5].

5. Board edge tolerance: ± 0.3 [± 10].

<https://www.pololu.com/product/4772>

Name:
Breakout for JST SH-Style Connector,
6-Pin Male Side-Entry

Item number:
4772, 4773

Drawing date:
13 June 2025

Dev code:
con01a

Units: mm
[mil]

Material:
mixed

Pololu
Robotics & Electronics
© 2025 Pololu Corporation