

## Specifications

Current rating: 3A AC,DC

Voltage rating: 250V AC,DC

Temperature range: -25°C ~ +85°C

Contact resistance: 10mΩ Max.

Insulation resistance: 1000MΩ Min.

Withstanding voltage: 1000V AC/minute

## Assembly layout

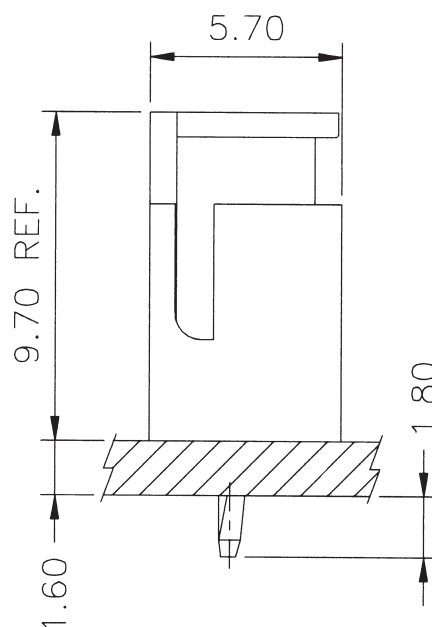
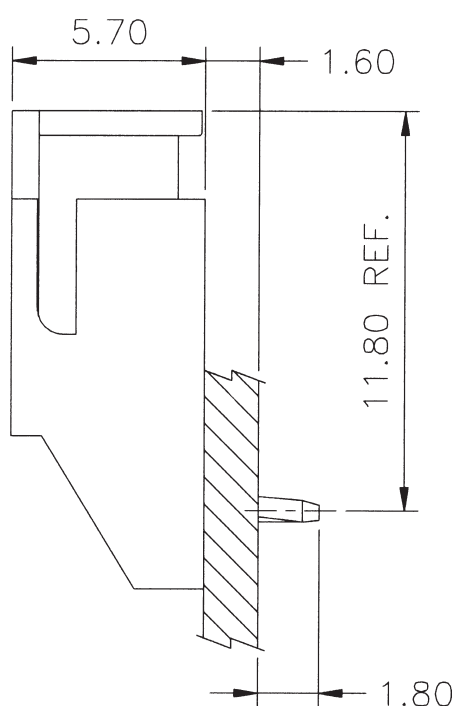

## A2501-T — 2.50mm pitch Crimp Terminal

### Reference Informations:

\*Used in CJT A2501 series Housing

\*Tolerance:(unit:mm) .0 ±0.25/ .00 ±0.15/ .000 ±0.10

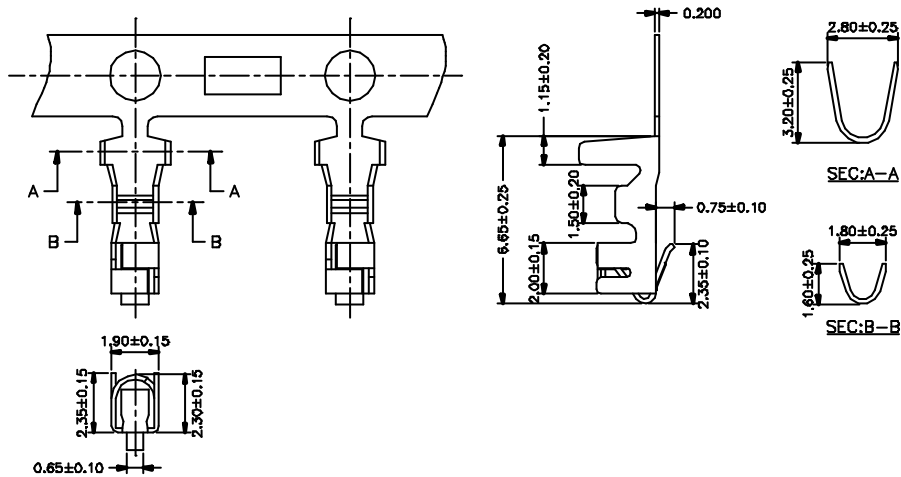

### Ordering Information & Specifications:

Unit:mm

Part No.	Wire Range	Insulation O.D.	Material	Finish	Qty/reel
A2501-TB	AWG#22-#28	1.90mm(max)	Brass	Tin-plated	8,000pcs
A2501-TP	AWG#22-#28	1.90mm(max)	Phosphor Bronze	Tin-plated	8,000pcs

## A2501H — 2.50mm pitch Housing

### Reference Informations:

\*Material: Nylon 66,UL94V-0

\*Suitable CJT A2501 series Terminal

\*Mates with CJT A2501 series Wafer

\*Tolerance:(unit:mm) .0 ±0.25/ .00 ±0.15/ .000 ±0.10

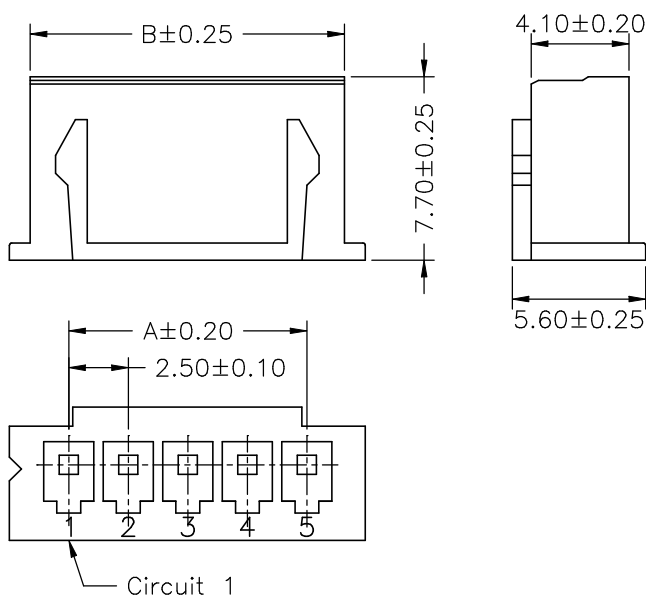
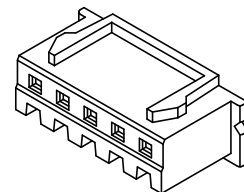

### Ordering Information & Dimensions:

PART NO.	Dimensions	
	A	B
A2501H-2P	2.50	5.70
A2501H-3P	5.00	8.20
A2501H-4P	7.50	10.70
A2501H-5P	10.00	13.20
A2501H-6P	12.50	15.70
A2501H-7P	15.00	18.20
A2501H-8P	17.50	20.70
A2501H-9P	20.00	23.20
A2501H-10P	22.50	25.70
A2501H-11P	25.00	28.20
A2501H-12P	27.50	30.70
A2501H-13P	30.00	33.20
A2501H-14P	32.50	35.70
A2501H-15P	35.00	38.20
A2501H-16P	37.50	40.70
A2501H-17P	40.00	43.20
A2501H-18P	42.50	45.70
A2501H-19P	45.00	48.20
A2501H-20P	47.50	50.70

Unit:mm

## A2501M-T

2.50mm pitch Crimp Terminal

### Reference Informations:

\*Used in CJT A2501HM series Housing

\*Tolerance:(unit:mm) .0 ±0.25/ .00 ±0.15/ .000 ±0.10

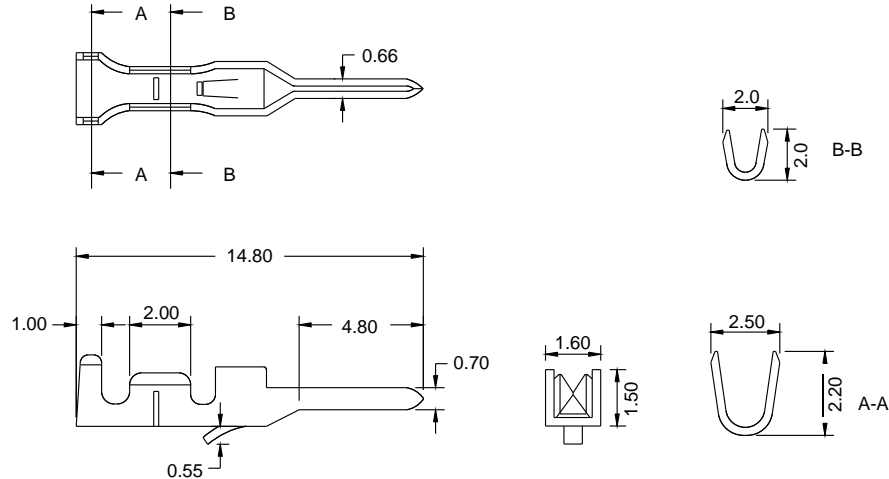

### Ordering Information & Specifications:

Unit:mm

Part No.	Wire Range	Insulation O.D.	Material	Finish	Qty/reel
A2501M-TB	AWG#22-#28	1.90mm(max)	Brass	Tin-plated	15,000pcs

## A2501HM

2.50mm pitch Housing

### Reference Informations:

\*Material: Nylon 66,UL94V-0

\*Suitable CJT A2501M series Terminal

\*Tolerance:(unit:mm) .0 ±0.25/ .00 ±0.15/ .000 ±0.10

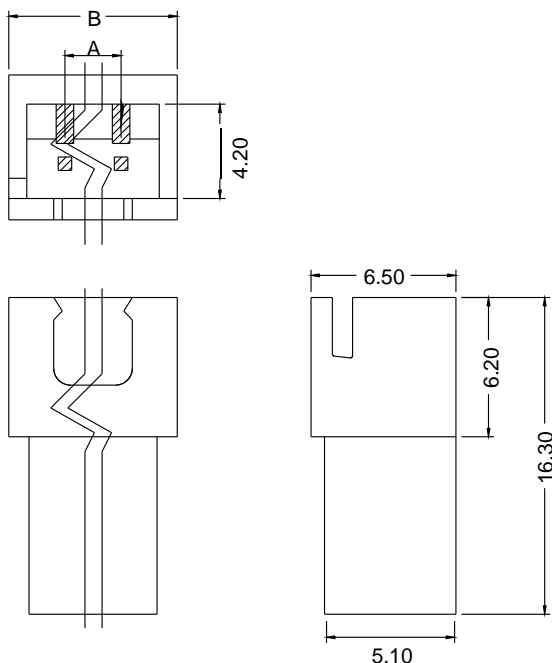

### Ordering Information & Dimensions:

PART NO.	Dimensions	
	A	B
A2501HM-2P	2.50	7.50
A2501HM-3P	5.00	10.00
A2501HM-4P	7.50	12.50
A2501HM-5P	10.00	15.00
A2501HM-6P	12.50	17.50
A2501HM-7P	15.00	20.00
A2501HM-8P	17.50	22.50
A2501HM-9P	20.00	25.00
A2501HM-10P	22.50	27.50
A2501HM-11P	25.00	30.00
A2501HM-12P	27.50	32.50
A2501HM-13P	30.00	35.00
A2501HM-14P	32.50	37.50
A2501HM-15P	35.00	40.00
A2501HM-16P	37.50	42.50
A2501HM-17P	40.00	45.00
A2501HM-18P	42.50	47.50
A2501HM-19P	45.00	50.00
A2501HM-20P	47.50	52.50

Unit:mm

## A2501MJ-T

2.50mm pitch Crimp Terminal

### Reference Informations:

\*Used in CJT A2501HM series Housing

\*Tolerance:(unit:mm) .0 ±0.25/ .00 ±0.15/ .000 ±0.10

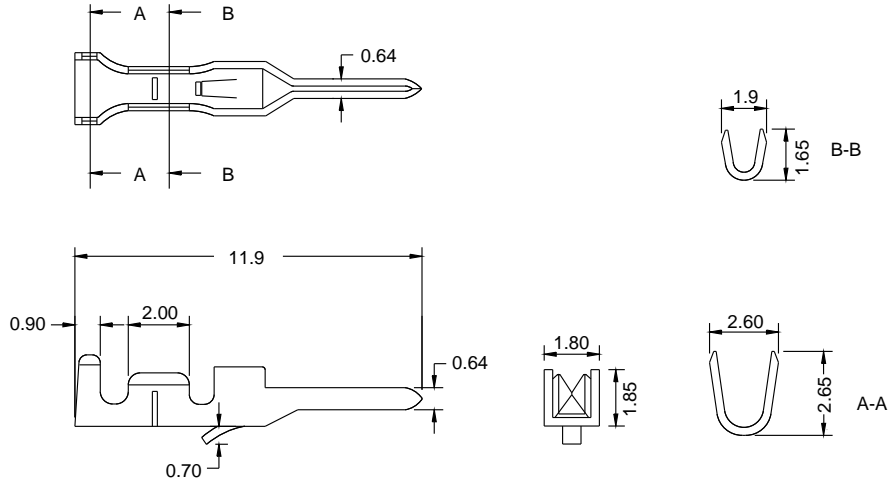

### Ordering Information & Specifications:

Unit:mm

Part No.	Wire Range	Insulation O.D.	Material	Finish	Qty/reel
A2501MJ-TB	AWG#22-#28	1.90mm(max)	Brass	Tin-plated	10,000pcs

## A2501HMJ-2P

2.50mm pitch Housing

### Reference Informations:

\*Material: Nylon 66,UL94V-0

\*Suitable CJT A2501MJ series Terminal

\*Tolerance:(unit:mm) .0 ±0.25/ .00 ±0.15/ .000 ±0.10

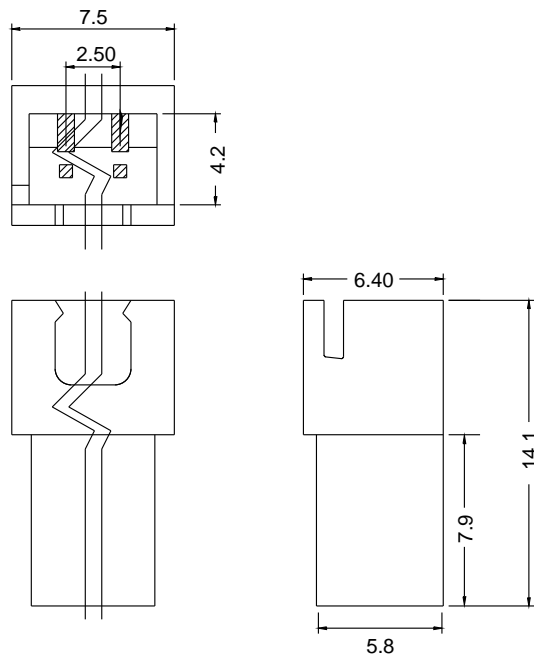

## A2501WV

2.50mm pitch 180° Wafer

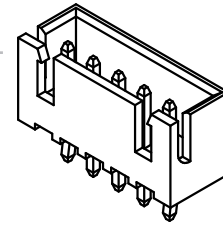

### Reference Informations:

\*Material: Pin: Brass/Tin-plated

Wafer: Nylon 66,UL94V-0

\*Mates with CJT A2501 series Housing

\*Nylon 46 is available

\*Tolerance:(unit:mm) .0 ±0.25/ .00 ±0.15/ .000 ±0.10

Ordering Information:  
A2501WV-XP-X-46

1.Part No.  
2.Style:  
1-Type 1  
2-Type 2  
3-Type 3

Ordering Information & Dimensions:

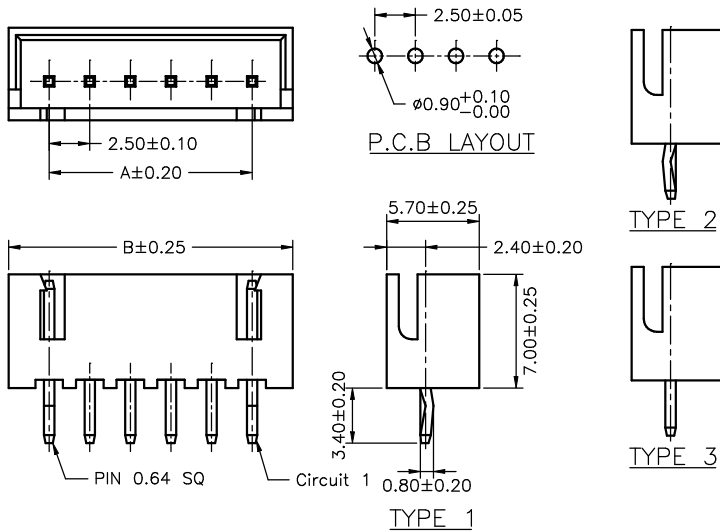

PART NO.	Dimensions	
	A	B
A2501WV-2P	2.50	7.50
A2501WV-3P	5.00	10.00
A2501WV-4P	7.50	12.50
A2501WV-5P	10.00	15.00
A2501WV-6P	12.50	17.50
A2501WV-7P	15.00	20.00
A2501WV-8P	17.50	22.50
A2501WV-9P	20.00	25.00
A2501WV-10P	22.50	27.50
A2501WV-11P	25.00	30.00
A2501WV-12P	27.50	32.50
A2501WV-13P	30.00	35.00
A2501WV-14P	32.50	37.50
A2501WV-15P	35.00	40.00
A2501WV-16P	37.50	42.50
A2501WV-17P	40.00	45.00
A2501WV-18P	42.50	47.50
A2501WV-19P	45.00	50.00
A2501WV-20P	47.50	52.50

Unit:mm

## A2501WV-F

2.50mm pitch 180° Wafer - With Boss

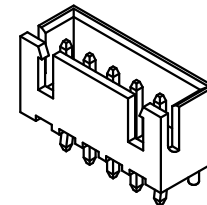

### Reference Informations:

\*Material: Pin: Brass/Tin-plated

Wafer: Nylon 66,UL94V-0

\*Mates with CJT A2501 series Housing

\*Nylon 46 is available

\*Tolerance:(unit:mm) .0 ±0.25/ .00 ±0.15/ .000 ±0.10

Ordering Information & Dimensions:

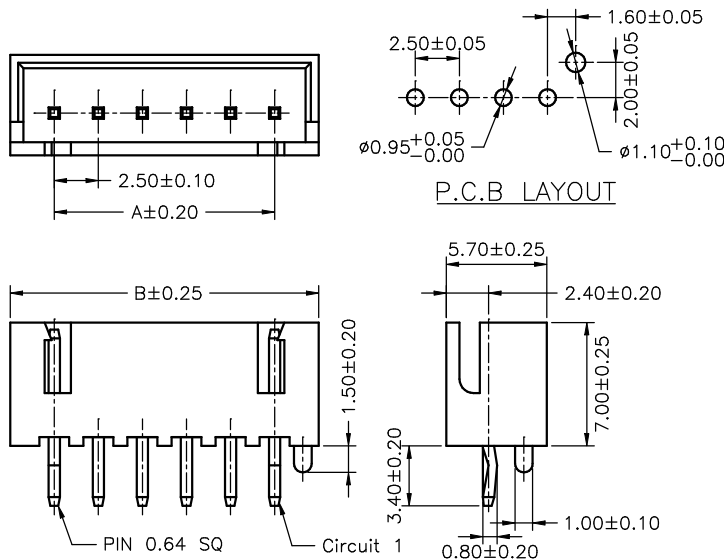

PART NO.	Dimensions	
	A	B
A2501WV-F-2P	2.50	7.50
A2501WV-F-3P	5.00	10.00
A2501WV-F-4P	7.50	12.50
A2501WV-F-5P	10.00	15.00
A2501WV-F-6P	12.50	17.50
A2501WV-F-7P	15.00	20.00
A2501WV-F-8P	17.50	22.50
A2501WV-F-9P	20.00	25.00
A2501WV-F-10P	22.50	27.50
A2501WV-F-11P	25.00	30.00
A2501WV-F-12P	27.50	32.50
A2501WV-F-13P	30.00	35.00
A2501WV-F-14P	32.50	37.50
A2501WV-F-15P	35.00	40.00
A2501WV-F-16P	37.50	42.50
A2501WV-F-17P	40.00	45.00
A2501WV-F-18P	42.50	47.50
A2501WV-F-19P	45.00	50.00
A2501WV-F-20P	47.50	52.50

Unit:mm

## A2501WR

2.50mm pitch 90° Wafer

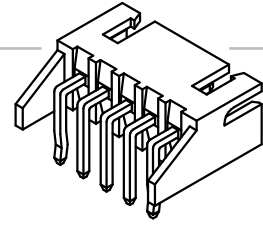

### Reference Informations:

- \*Material: Pin: Brass/Tin-plated  
Wafer: Nylon 66,UL94V-0
- \*Mates with CJT A2501 series Housing
- \*Nylon 46 is available
- \*Tolerance:(unit:mm) .0 ±0.25/ .00 ±0.15/ .000 ±0.10

### Ordering Information:

A2501WR-XP-X-46  
 1 2  
 1.Part No.  
 2.Style:  
 1-Type 1  
 2-Type 2

### Ordering Information & Dimensions:

PART NO.	Dimensions	
	A	B
A2501WR-2P	2.50	7.50
A2501WR-3P	5.00	10.00
A2501WR-4P	7.50	12.50
A2501WR-5P	10.00	15.00
A2501WR-6P	12.50	17.50
A2501WR-7P	15.00	20.00
A2501WR-8P	17.50	22.50
A2501WR-9P	20.00	25.00
A2501WR-10P	22.50	27.50
A2501WR-11P	25.00	30.00
A2501WR-12P	27.50	32.50
A2501WR-13P	30.00	35.00
A2501WR-14P	32.50	37.50
A2501WR-15P	35.00	40.00
A2501WR-16P	37.50	42.50
A2501WR-17P	40.00	45.00
A2501WR-18P	42.50	47.50
A2501WR-19P	45.00	50.00
A2501WR-20P	47.50	52.50

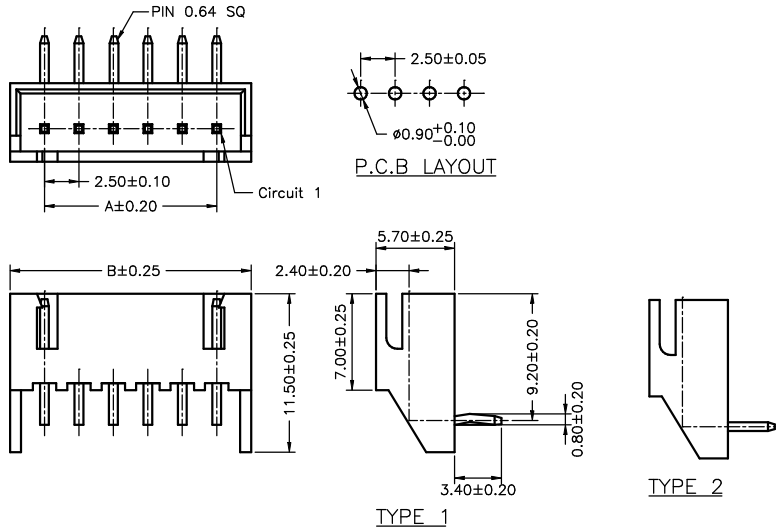

Unit:mm

## A2501WVR

2.50mm pitch 90° Wafer

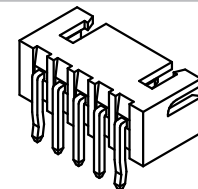

### Reference Informations:

- \*Material: Pin: Brass/Tin-plated  
Wafer: Nylon 66,UL94V-0
- \*Mates with CJT A2501 series Housing
- \*Nylon 46 is available
- \*Tolerance:(unit:mm) .0 ±0.25/ .00 ±0.15/ .000 ±0.10

### Ordering Information:

A2501WVR-XP-X-46  
 1 2  
 1.Part No.  
 2.Style:  
 1-Type 1  
 2-Type 2

### Ordering Information & Dimensions:

PART NO.	Dimensions	
	A	B
A2501WVR-2P	2.50	7.50
A2501WVR-3P	5.00	10.00
A2501WVR-4P	7.50	12.50
A2501WVR-5P	10.00	15.00
A2501WVR-6P	12.50	17.50
A2501WVR-7P	15.00	20.00
A2501WVR-8P	17.50	22.50
A2501WVR-9P	20.00	25.00
A2501WVR-10P	22.50	27.50
A2501WVR-11P	25.00	30.00
A2501WVR-12P	27.50	32.50
A2501WVR-13P	30.00	35.00
A2501WVR-14P	32.50	37.50
A2501WVR-15P	35.00	40.00
A2501WVR-16P	37.50	42.50
A2501WVR-17P	40.00	45.00
A2501WVR-18P	42.50	47.50
A2501WVR-19P	45.00	50.00
A2501WVR-20P	47.50	52.50

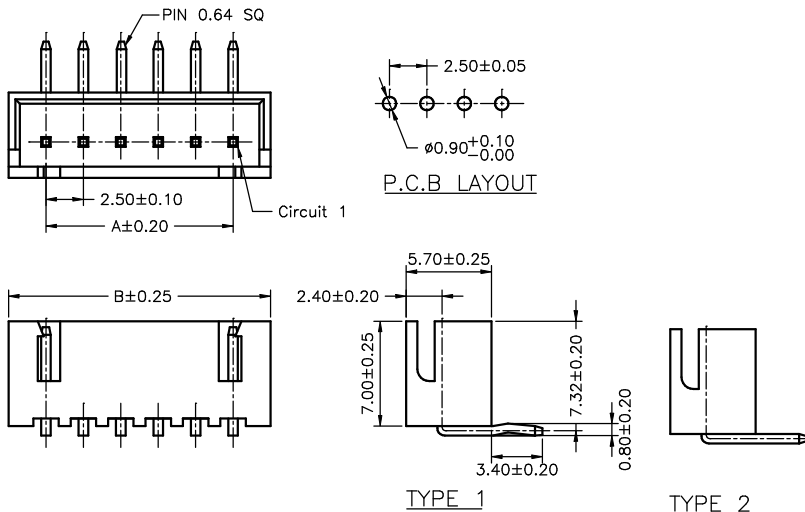

Unit:mm

### A2501

2.50mm pitch Wafer

#### Reference Informations:

\*Material: Insulato: Nylon 66 UL 94V-0

Contact Post: Phosphor Bronze, Tin-plated

\*Mates with CJT A2501 series wafer

\*Tolerance: (unit:mm) .0 ±0.25/ .00 ±0.15/ .000 ±0.10

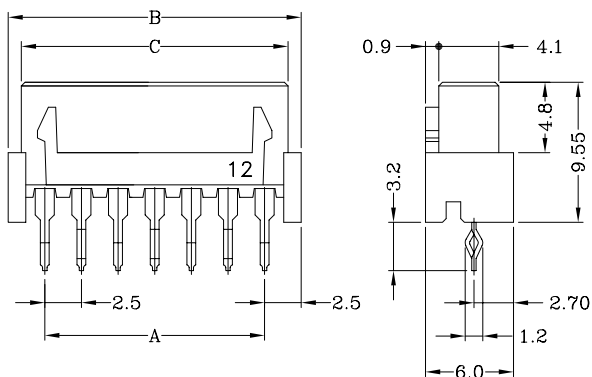
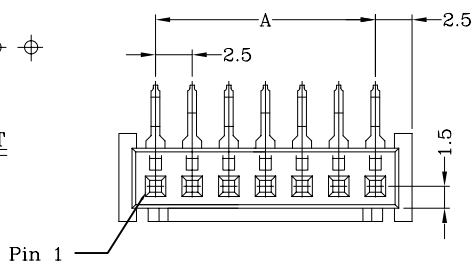
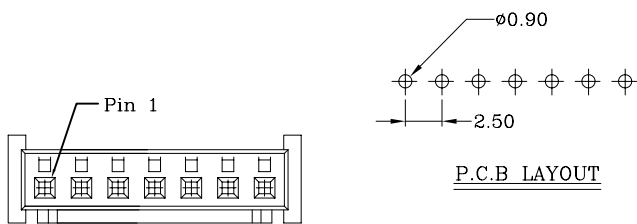
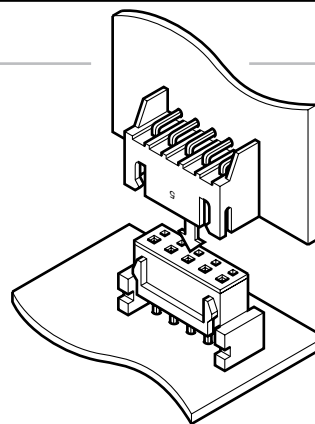

Straight angle

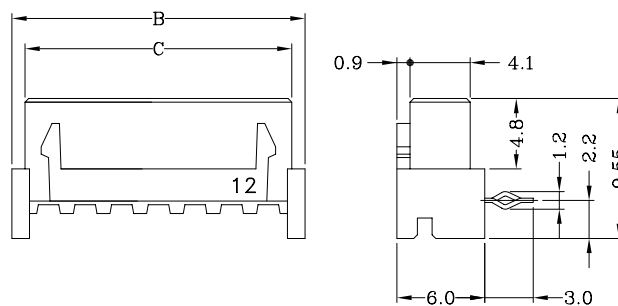

Right Angle

Part No		Dimensions			PCS/BOX
Straight angle	Right Angle	A	B	C	
A2501HWV-3P	A2501HWR-3P	5.00	10.00	8.20	500
A2501HWV-4P	A2501HWR-4P	7.50	12.50	10.70	500
A2501HWV-5P	A2501HWR-5P	10.00	15.00	13.20	500
A2501HWV-6P	A2501HWR-6P	12.50	17.50	15.70	500
A2501HWV-7P	A2501HWR-7P	15.00	20.00	18.20	250
A2501HWV-8P	A2501HWR-8P	17.50	22.50	20.70	250
A2501HWV-9P	A2501HWR-9P	20.00	25.00	23.20	250
A2501HWV-10P	A2501HWR-10P	22.50	27.50	25.70	250
A2501HWV-11P	A2501HWR-11P	25.00	30.00	28.20	200
A2501HWV-12P	A2501HWR-12P	27.50	32.50	30.70	200
A2501HWV-13P	A2501HWR-13P	30.00	35.00	33.20	200
A2501HWV-14P	A2501HWR-14P	32.50	37.50	35.70	100
A2501HWV-15P	A2501HWR-15P	35.00	40.00	38.20	100